

Quality 1z0-1071-22 PDF Dumps - 1z0-1071-22 Exam Questions [Q37-Q51]

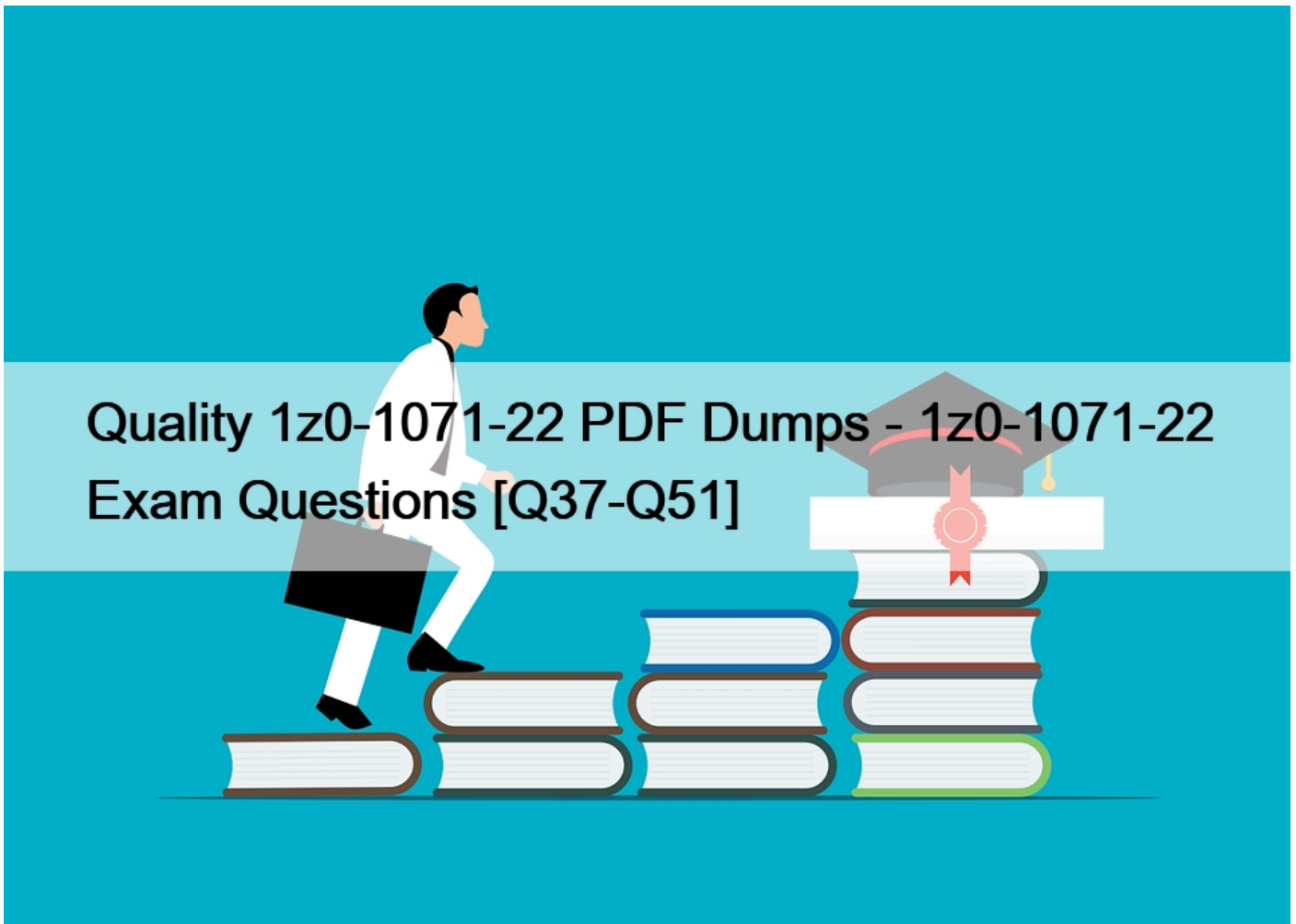

Quality 1z0-1071-22 PDF Dumps - 1z0-1071-22 Exam Questions
Most UptoDate Oracle 1z0-1071-22 Exam Dumps PDF 2022

QUESTION 37

Which three statements are FALSE regarding entity resolution using a composite bag?

- * You can define multiple prompts for each entity item in the composite bag.
- * The composite bag will automatically resolve any entity values found in the initial user input.
- * When a user inputs entity values, they can only be resolved in the order in which they are defined within the composite bag.
- * Each entity item in the composite bag can have only one value.
- * Every entity item in the composite bag must be prompted for and have a value entered.
- * You can define validation code using Apache Freemarker for entity item values.

QUESTION 38

You install Oracle Bost Node SDK from GitHub to develop a new custom component service.

Which command, when issued on a command line or terminal window, creates a new custom component service project in the current directory?

- * bots-node-sdk service
- * bots-node-sdk service init
- * bots-node-sdk npm install
- * bots-node-sdk init

Explanation

Create the Custom Component Package

Use the SDK's command line interface (CLI) to create the necessary files and directory structure.

To create the package folder, and the necessary contents, type the following command in a terminal window:

```
bots-node-sdk init <top-level folder path>
```

<https://docs.cloud.oracle.com/en-us/iaas/digital-assistant/doc/backend-integration1.html>

QUESTION 39

Which is NOT used to tune routing behavior?

- * the classifier's F1-score
- * the built-in system intent confidence threshold
- * the confidence win margin
- * candidate skills' confidence thresholds

QUESTION 40

intent has been configured with a composite bag entity.

Which statement is FALSE?

- * The skill may allow users to update their previous input.
- * The conversation is entirely sequential, where users can only input values in the order determined by the dialog flow definition.
- * The composite bag entity slots values as they are provided from the user input. It then prompts for other entity item values.
- * The composite bag entity is typically resolved using a system.ResolveEntities component or a system.commonResponse component.

QUESTION 41

Imagine that you have a financial planning skill. Which two functionalities would typically be implemented as a custom component?

- * displaying any type of input component
- * routing the dialog flow based on values returned from a backend service
- * returning the current value of a requested stock price in a skill message
- * running the skill within a webpage
- * routing to another skill within the suite of skills assembled within a digital assistant

QUESTION 42

Consider the following dialog flow code in a skill:

```
wait:
  component: "System.Output"
  properties:
    text: "Please wait, we're reviewing your order"
    keepTurn: true
  transitions:
    next: "waitmore"

waitmore:
  component: "System.Output"
  properties:
    text: "Almost done..."
    keepTurn: false
  transitions:
    next: "printIt"

printIt:
  component: "System.Output"
  properties:
    keepTurn: true
    text: "Thank you for your order."
  transitions:
    return: "done"
```

Which statement is true?

* The skill displays the message "Please wait, we're reviewing your order"; then it displays

"Almost done"; then it displays "Thank you for your order"; and then it completes the conversation.

* The skill displays the message "Please wait, we're reviewing your order"; and then it waits for user input.

* The skill displays the message "Please wait, we're reviewing your order"; then it displays

"Almost done"; and then it waits for user input.

* The skill displays the message "Please wait, we're reviewing your order"; then it displays "Almost done"; then it displays "Thank you for your order"; and then it waits for user input.

QUESTION 43

You are designing a skill for a railway company. You created a value list entity (StationEntity), which is the list of all possible train stations. To resolve an intent (RouteIntent), you need to determine whether the user is asking for a route which is either to a station or from a station.

Which statement describes the most robust and efficient approach for extracting this information from the user input?

* Create a value list entity called ToFromEntity with values of "to" and "from"; and with appropriate synonyms for each value. Create a value list called DirectionStation and add ToFromEntity and StationEntity to this. Then, add DirectionStation to the RouteIntent.

* Create two derived entities based on StationEntity. In one entity, set the preceding phrase to "to"; (along with any required synonyms). In the other entity, do the same but with the preceding phrase "from". Add both entities to the RouteIntent intent.

* Duplicate StationEntity. In one version, prefix all of the train station names with "to"; and in the other prefix with "from". Then add both entities to the RouteIntent intent.

* Add StationEntity to the RouteIntent intent and then update the training data with phrases beginning with "from".

QUESTION 44

Which statement is FALSE regarding out-of-order messages?

- * Out-of-order messages are not handled by default. Designers must define out-of-order message handlers at the skill level.
- * Dialog flow navigation continues with the state referenced in the out-of-order-message action.
- * Chatbots don't control the user's input and, therefore, cannot prevent users from selecting out-of-scope actions.
- * Out-of-order messages occur when a user scrolls the conversation history displayed in the messenger client and selects that is no longer in scope for the current conversation.

QUESTION 45

When testing your skill, you notice that two of its intents consistently rank as the top two, resolving within just a few points of each other.

Given the unpredictable nature of which intent gets the top score, what would you do to allow the skill user to choose the correct intent?

- * Change the Confidence Win Margin so that both intents are offered to the user.
- * Change the Confidence Threshold during your testing until the correct intent always wins.
- * For each intent, create an entity of phrases that are distinct to each intent, and add the appropriate entity to the corresponding intent.
- * Keep adding training data until you get a predictable result every time.
- * Change the Explicit Invocation Threshold to zero to ensure that the correct intent is picked up when the user mentions the name of the intent.

QUESTION 46

You have a use case that calls for users to enter a series of complex values.

What would you do to ensure that users enter these values correctly with the least effort?

- * Create a composite bag entity for the types of values, and then add a regex entity to handle validation.
- * Use a `system.commonResponseComponent` to aggregate and validate user input.
- * Create a webview service which connects the skill to a web app that renders as a form and provides features such as input validation and option buttons.
- * Create a dedicated skill for collecting and validating input and pair it with a skill for processing the validated input.

QUESTION 47

Which two statements are true for the `system.webview` component?

- * Parameters passed from the skill to the web application cannot be accessed through JavaScript.
- * Property names in the web application response payload must match with the variable names in the dialog flow.
- * When registering web applications in a skill, bot designers can see the data structure returned by the app.
- * Parameters passed from the skill to the web application are accessible through JavaScript.
- * The `webview.onDone` parameter is automatically added to the payload and passes the skill's callback URL property to the web application.

QUESTION 48

You are building a skill for ordering pizza and you need it to determine when a user enters the pizza toppings and pizza size in their request.

Which Oracle Digital Assistant feature would you use to identify these variable values in a user's message?

- * entities
- * answer intents

- * channels
- * digital assistants

QUESTION 49

What statement correctly describes the Authentication Service in Oracle Digital Assistant?

- * The Authentication Service authenticates users to Oracle Identity Cloud Service. It provides customizable login screens that are displayed in the context of a user-bot conversation.
- * The Authentication Service holds the identity provider configuration that is used at run time in Oracle Digital Assistant to retrieve an access token that authorizes REST service calls.
- * The Authentication Service authenticates Oracle Digital Assistant users to a social media identity provider (for example, Facebook) and associates social media accounts with accounts stored in the Oracle Identity Cloud Service.
- * The Authentication Service allows bot designers to configure a custom webhook to authenticate and authorize users using the System.OauthAccountLink component.

QUESTION 50

View the Exhibit.

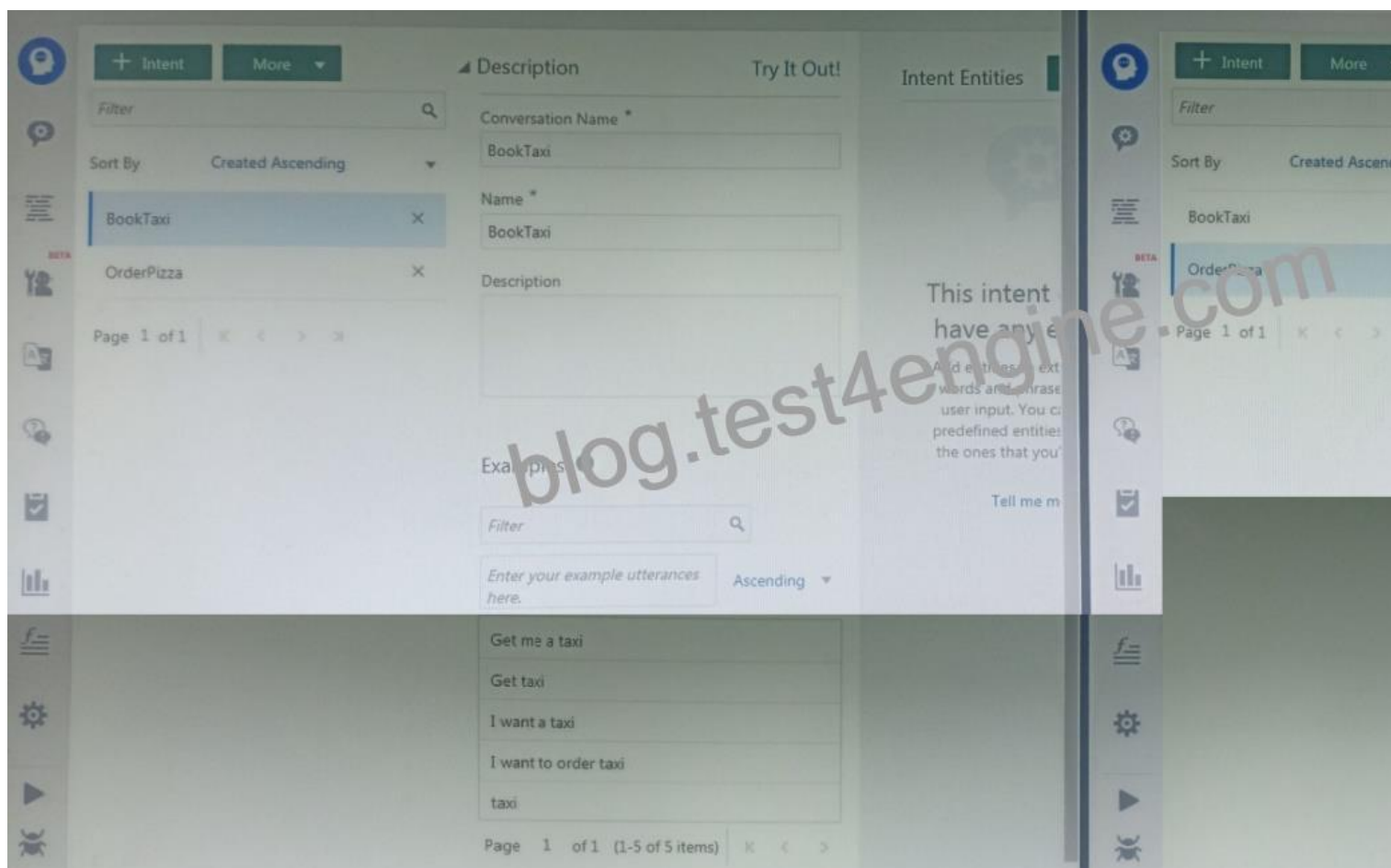

You have been asked to review a skill for its readiness for go live. Which four issues would you raise as a priority?

- * The unresolvedIntent has not been trained.
- * The utterances have too much commonality.

- * All utterances should start with an uppercase letter and end with a period.
- * The word "please"; may inadvertently skew the results.
- * You should never have single-word utterances.
- * The number of utterances looks to be too low and artificial for a go-live.

QUESTION 51

To prepare the remote application launch, the System.Webview component calls an intermediary service that prepare the remote web application call. The code snippet is given below:

```
callWebview:
  component: "System.Webview"
  properties:
    service: "oracletravelweb"
    sourceVariableList: "origin,destination"
    variable: "webviewresponse"
    prompt: "Press 'Open Oracle Travel' to complete your reservation"
    linkLabel: "Open Oracle Travel"
    cancelLabel: "Cancel"
  transitions:
    next: "evaluateWebviewResponse"
  actions:
    textReceived: "onCancel"
    cancel: "onCancel"
```

At run time, the system.Webview component sends the intermediary service a POST request. Which three options are true for the POST payload generated based on the code?

- * Bot designer is responsible to manually add the webview.onDone parameter to the payload.
- * The key names match the name of the dialog flow variables configured in the "sourceVariableList" property of the system.webview component.
- * The webview.onDone parameter is automatically added to the payload and it passes the skill's callback URL property to the web application.
- * The POST payload is a JSON object that contains an array of key-value pairs.
- * There is no such webview.onDone property passed to the payload.

100% Free Cloud Digital Assistant 1z0-1071-22 Dumps PDF Demo Cert Guide Cover:

https://www.test4engine.com/1z0-1071-22_exam-latest-braindumps.html